

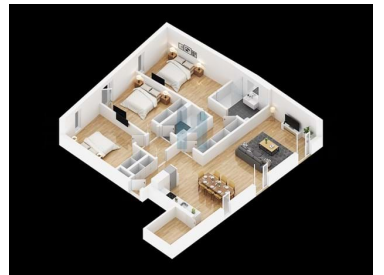

## Portimão - Development

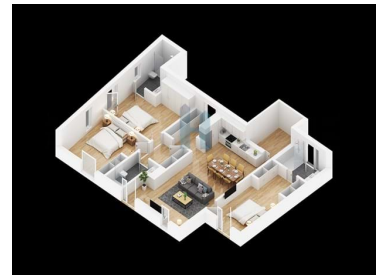
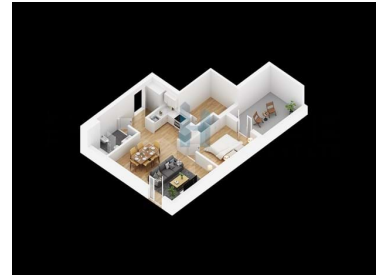

**N/A**  
(EUR €)

### New development in the center of Portimão

Located in the heart of the city of Portimão close to the accesses to the motorway and a variety of shops and services

The perfect harmony between modern construction inserted in the historic and typical area of this wonderful city

Large areas with a quality of construction that uses the most modern construction techniques, thermal and acoustic insulation.

Fully equipped kitchens.

High quality crockery and taps.

Do not miss the opportunity to acquire a dream apartment in this prestigious condominium that was the result of the rehabilitation of a historic building in the city.

Schedule your visit now



**Jorge Marrachinho**

925412292 <sup>2</sup>

jorge.m@thepenthouse.pt

**T +351 282 431 253 <sup>1</sup> · E info@thepenthouse.pt**  
**Rua do Sol, Ed. Elite Residence, Loja A, 8500-411 Portimão**  
**AMI 20698**

<sup>1</sup> (Call to national fixed network) | <sup>2</sup> (Call to national mobile network)



## Property Features



**Jorge Marrachinho**

925412292 <sup>2</sup>

jorge.m@thepenthouse.pt

**T +351 282 431 253 <sup>1</sup> · E info@thepenthouse.pt**  
**Rua do Sol, Ed. Elite Residence, Loja A, 8500-411 Portimão**  
**AMI 20698**

<sup>1</sup> (Call to national fixed network) | <sup>2</sup> (Call to national mobile network)